



Co147 Series

REVOLVING DOOR

Self-managed Security Revolving Door with metal detector and single passage checking system (tailgating and piggybacking detection systems).



Co147.180.D
Co147.180.S

SELF-MANAGED REVOLVING DOOR SINGLE PASSAGE CHECKING SYSTEM

Automated High Security Revolving Door for simultaneous bi-directional traffic with Metal Detector. It allows for users to enter and leave the building at the same time. It controls the single passage into each turnstile segment.

SELF-MANAGED REVOLVING DOOR
Installed on site, directly on the existing floor.



REMOVABLE
STRUCTURE



METAL DETECTOR
(built-in)

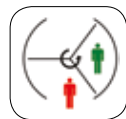

TAILGATING
(SINGLE PASSAGE
CHECKING SYSTEM)

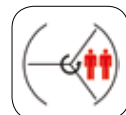

PIGGYBACKING
DETECTION SYSTEM



PRESENCE CHECKING
THROUGH ULTRASONIC
VOLUMETRIC SENSOR



ACCESS CONTROL
SYSTEMS INTEGRATION



FB4 BULLETPROOF
RES. STEEL STRUCTURE
(on Co147.DB/.SB)



BULLETPROOF
BURGLAR PROOF

Certified glass according to EN1063:

Turnstile glass: BR1/S and P4B
Structure glass: BR2/S and P6B
(optional: structure glass BR4/S)



Co147.DA/.DB and .SA/.SB Revolving Doors, available versions:

Model	Dimensions	Passage	Base floor	Metal Detector	Door	Glass	Turnstile	Structure
Co147.180.DA								Steel
Co147.180.DB	Ø 1800 H 2375mm	W 750 H 2090mm	Without base	Built-in (removed on request)	2-leaves door	Int. BR1/S Ext. BR2/S	3 wings Turnstile	Additional FB4 steel panels
Co147.180.SA	Ø 5.9055' H 7.792'	W 2.4606' H 6.857'			1-leaf door	on request: Ext. BR4/S with 30/31 mm	4 wings (optional)	Steel
Co147.180.SB								Additional FB4 steel panels

“ The best security access control solution for high flow prestigious places.

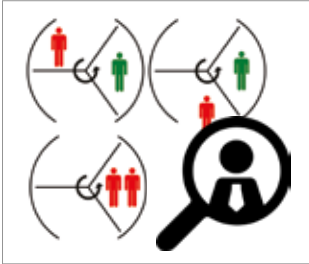

FLOW MANAGEMENT SYSTEM

The door system **controls the single authorized passage into each turnstile segment**. At the same time door sensors guarantee: tailgating and piggybacking detection, blocking the unauthorized people and any kind of multiple accesses in the same turnstile partition.

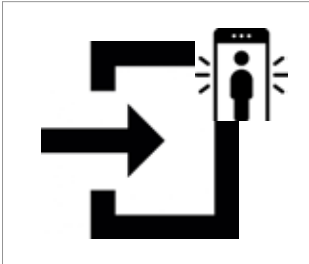

ELEGANT HIGH SECURITY ENTRANCE

Built-in CEIA Metal Detector, (CF version has the best sensitivity for firearms detection, discriminating personal metal objects like smartphones and keys). Revolving doors are an elegant solution for entrances of: museums, schools, hotels, shopping malls, airports, meeting centers, data centers, companies, industries, stadiums. Co147.D series is equipped with a **2-leaves sliding-door** on protected side and Co147.S series with a **1-leaf sliding-door**.



FB4 REINFORCED STRUCTURE

Co147.DB and .SB are special versions with a reinforced structure thanks to additional bulletproof steel panels (FB4 grade according to EN 1522). All models can be equipped with 30/31mm BR4/S certified external glass according to EN 1063 (on request, optional).



ACCESS CONTROL SYSTEMS

It is an **excellent solution as access control gate** for prestigious places or areas with restricted/conditioned access, thanks to the integration with badge/proximity readers, fingerprint acquisition, face detection systems or any other biometric solution (optional, mounted on external side or column).



EQUIPMENT & ACCESSORIES

- Removable structure: installed on site, directly on the existing floor
- Person presence checking system with volumetric sensors
- Anti-taigating system: people detection, one following the other on different segments
- Anti-piggybacking system: two people detection, even if one takes in arms the other
- Door on protected side: a 2-leaves door (Co147.D), a 1-leaf door (Co147.S)
- Metal Detector (built-in, can be removed on request)
- Portal management unit/console with program functions and LCD display
- Traffic light panels with intercom
- Multilingual voice messages
- Interfacing to access control systems / presence detection systems (RS485)
- Integration with badge readers or fingerprints acquisition systems (optional)
- Interior lighting: lights LED strips
- Emergency system: automatic unlocking system
- Mechanical lock for additional locking during the night-times
- Anti-drilling armored defender for key cylinder protection (optional)
- Reinforced steel structure with additional FB4 panels: on Co147.DB and .SB versions
- Rain cover: honeycomb PVC cover cap panel, UV resistant
- Reinforced upper cover: steel panel for cap protection (optional)

Co147 VERSIONS

Two versions: Co147.180.D (Ø1800 mm), Co147.180.S (Ø1800 mm).



Honeycomb PVC cover cap panel, UV resistant.



Steel panel for cap cover (optional).



Anti-drilling armored defender for key cylinder protection (optional).

Co147 TECHNICAL FEATURES



WEIGHT: from 1984 to about 3086 lbs 900/1400 Kg depending on version and accessories.



POWER SUPPLY & OPERATING VOLTAGE: 100-240 V, 50-60 Hz; 24 V.c.c. with batteries for activity without power supply.



TRANSIT CAPACITY: at the standard speed of 4 turns per minute, the 3-sector turnstile guarantees a bidirectional flow of 12 passages per min. (without alarms).



STRUCTURE: painted steel, supplied disassembled, to be assembled on site. Co147.DB and .SB are equipped with additional bulletproof steel panels.



PAINTING: standard RAL colors with fine finish (glossy finish, stainless steel and special colors on request).



PROGRAMMABLE FUNCTIONS: emergency/block; automatic/manual transit; passage: mono/bidirectional.



EXTERNAL GLASS: side panels 53/64" 20/21mm bulletproof BR2/S and burglar proof P6B laminated glass (optional: 7/32" 30/31mm BR4/S and P8B).



INTERNAL GLASS (turnstile): laminated glass 35/64" 13/14mm BR1/S and P4A.



CONSUMPTION: Idle 50W, Turning (in motion) from 100 to 150W depending on the versions and accessories.



MOVEMENT: electromechanical drive by 24V DC motor with reversible movement of the turnstile in absence of supply voltage.



LIGHTING: interior compartment with 4 Led strips 12V-50/60Hz.



ELECTRONICS: control logic developed by CoMETA, microprocessor control and self-diagnosis.



SAFETY / ACCIDENT PREVENTION: sensitive electrical edges certified according to EN12978 (anti-crushing)

DIMENSIONS SCHEMA

Size and perspectives:

Co147.D

Co147.S

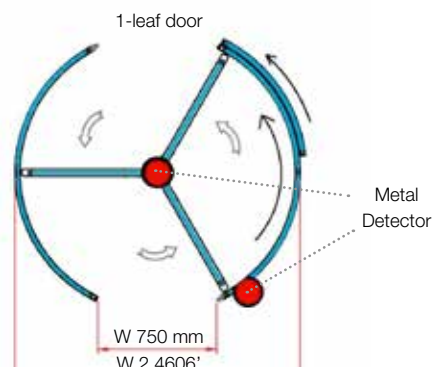
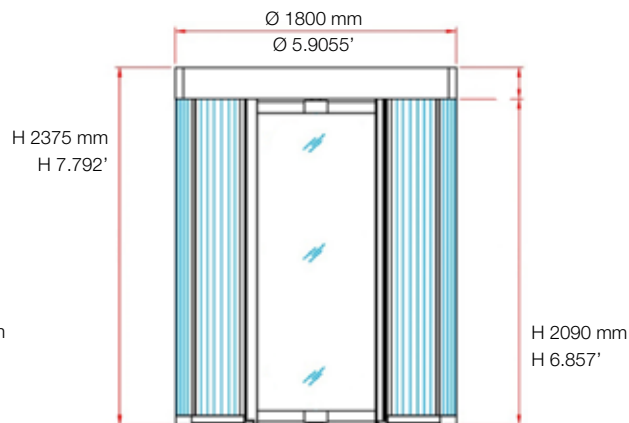
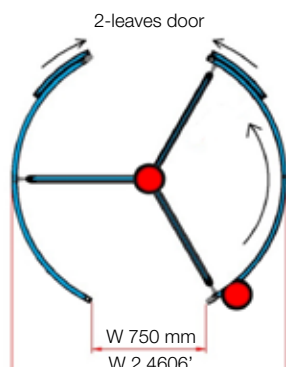
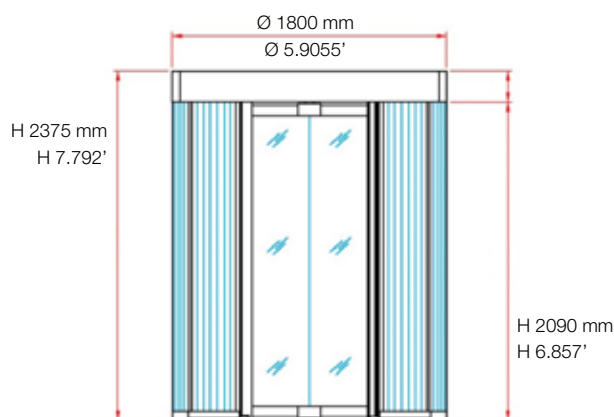

OPERATION MODES

	SITUATION	OPERATING MODE
	Authorized access request	The turnstile will rotate three times; if no access has been detected by the end of third rotation, the turnstile will stop in its standby position and a new access request must be made.
	Authorized access attempt during the third rotation after the access request.	The turnstile will stop and a vocal message will alert the user that access is unauthorized. The door's leaves will remain closed, to allow the user to exit from the same side he entered.
	Authorized access (either from the same or the opposite side) while the turnstile is already rotating.	The turnstile rotation counter will reset and a new cycle of three rotations will start.
	Unauthorized access request.	The turnstile will not move.
	Tailgating* : unauthorized access attempt (either from the same or the opposite side) while the turnstile is already rotating.	The turnstile will rotate opening the door's leaves to allow the authorized user to exit, while a vocal message will alert the unauthorized user, closing the door's leaves to allow the user to exit from the same side he entered.
	Piggybacking* : access attempted by two or more users in the same turnstile compartment.	The turnstile will stop and a vocal message will alert the users about the unauthorized access. The door's leaves will remain closed to allow the users to exit from the same side they entered.
	The user is about to be crushed due to the rotation, between turnstile edge and door frame.	The turnstile will immediately invert the direction of rotation to prevent contact and allow free movement.

Access requests can be made automatically (through presence detection sensors) or manually (through access control devices or push-button devices), depending on the customer's preference. The standard door transit program is bi-directional, meaning that the transit can be both outgoing and ingoing. The transit program can be modified at any time from the console settings. The door rotation is counterclockwise by default.

In the table is given a list of possible situations and the consequent modes of operation.

*Anti-tailgating and anti-piggybacking are optional features, which must be requested upon order.

REVOLVING DOORS COMPARISON

Co146-Co147 SERIES

CoMETA Revolving Doors models comparison table.



Model	Dimensions	Passage	Door	Metal Detector	Floor base	Turnstile	Glass	Structure	Weight
Co146.160.NA	Ø 1600 mm H 2325 mm Ø 5.2493' H 7.628'	W 660 mm H 2090 mm W 2.1654' H 6.857'	No	No	Without base	3 wings		Steel	
Co146.160.NB								Additional FB4 steel panels	
Co146.180.NA	Ø 1800 mm H 2325 mm Ø 5.9055' H 7.628'	W 750 mm H 2090 mm W 2.4606' H 6.857'				3 wings (4 wings optional)	Int: 13/14 mm (35/64") BR1/S - P4A	Steel	1873 / 2976 lbs
Co146.180.NB							Ext: 20/21mm (53/64") BR2/S - P6B	Additional FB4 steel panels	850 / 1350 Kg
Co146.230.NA	Ø 2300 mm H 2325 mm Ø 7' 6,551" H 7.628'	L 1400 mm H 2090 mm W 2' 5,527" H 6.857'				4 wings		Steel	
Co146.230.NB								Additional FB4 steel panels	
Co147.180.DA	Ø 1800 mm H 2375 mm Ø 5.9055' H 7.792'	W 750 mm H 2090 mm W 2.4606' H 6.857'	2-leaves door	Yes	Without base	3 wings (4 wings optional)	Int: 13/14 mm (35/64") BR1/S - P4A	Steel	1984 / 3086 lbs
Co147.180.DB							Ext. & Door: 20/21mm (53/64") BR2/S - P6B	Additional FB4 steel panels	900 / 1400 Kg
Co147.180.SA	Ø 1800 mm H 2375 mm Ø 5.9055' H 7.792'	W 750 mm H 2090 mm W 2.4606' H 6.857'	1-leaf door	Yes	Without base	3 wings (4 wings optional)	Int: 13/14 mm (35/64") BR1/S - P4A	Steel	1984 / 3086 lbs
Co147.180.SB							Ext. & Door: 20/21mm (53/64") BR2/S - P6B	Additional FB4 steel panels	900 / 1400 Kg

CUSTOM VERSIONS

Available on request, **different kind of customization**. CoMETA is able to respond promptly to the customer needs and develop specific tailor-made projects. Versions Ø1600 and Ø2300 are on request / project.

- 4 wings internal turnstile for Co146 Ø1800 and Ø2300, and for Co147 Ø1800
- Integration with access control systems (badge, fingerprints)
- Special colors painting /finishing
- Higher security grade glass:
 - Structure glass: 30/31mm BR4/S bulletproof certification



Certifications

All the certifications constitute a valid reference point for those who demand high performance, quality and reliability. CoMETA achieved important international certifications.

Product certifications: CoMETA products are **always tested** by our internal testing department and certified by Qualified Organizations on specific anti-burglary grades (following regulations and laws).

Burglar proof levels are tested in accordance with international standards, on: external structure, glass, security locks, security doors and protection elements.



CoMETA achieved important international certifications: ISO9001 certified quality systems, OHSAS18001 occupational health and safety assessment series, ISO14001 environmental management system.



CoMETA S.p.A.

Headquarters - Florence, Italy

Via Leonardo da Vinci, 116 - 50028 Barberino Tavarnelle

Tel: +39 055 8070303 - Fax: +39 055 8070505

info@cometaspa.com

www.cometaspa.com

CoMETA France

Headquarters

Paris, France

33, Rue des Chardonnerets
ZAC de Paris Nord II

93290 Tremblay En France

Tel.: +33 (0)1 48630204

Fax: +33 (0)1 48630280

info@cometafrance.com

www.cometafrance.com

CoMETA Milano

Branch

Milan, Italy

Tel.: +39 02 25551600

infomi@cometaspa.com

CoMETA Padova

Branch

Padua, Italy

Viale del lavoro, 70

Z.I. Roncagette

35020 Ponte S. Niccolò

Tel.: +39 049 8966592

Fax: +39 049 719295

infopd@cometaspa.com

